

ADD ARROW(S) IF NEEDED

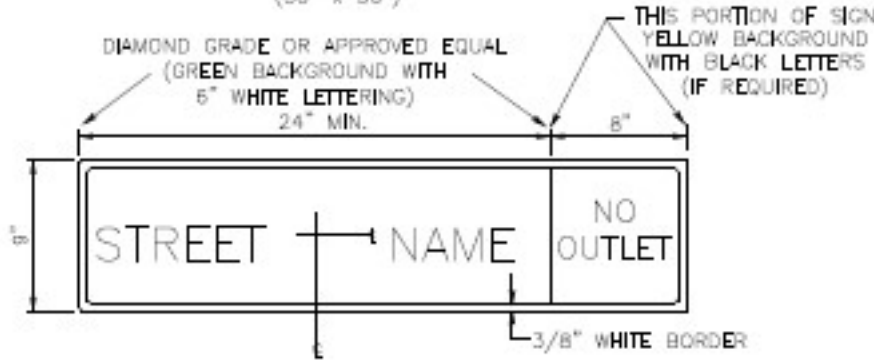

R1-1  
(30" x 30")



NOTES:

1. SIGNS ARE TO BE MADE OF ALUMINUM, .125" THICK, FLAT BLADE, DOUBLE FACED.

**DETAIL OF STANDARD STREET NAME SIGN**

N.T.S.

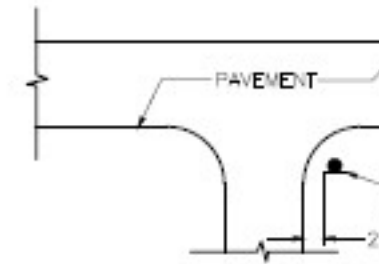

**STOP SIGN LOCATION**

N.T.S.

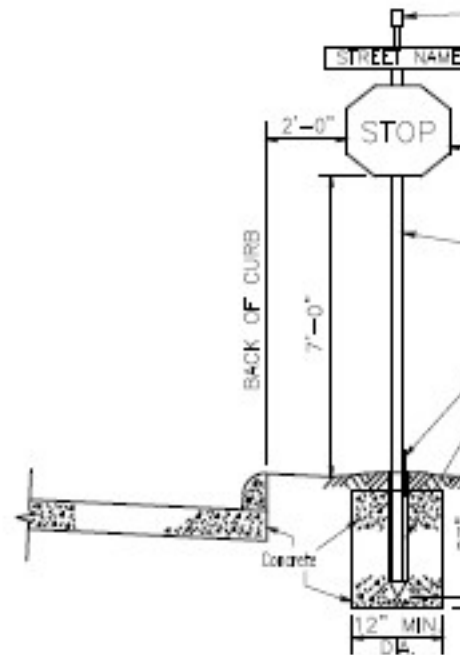

**TYPICAL SIGN MOUNT**

N.T.S.

**1 STREET SIGN DETAILS**